

# FOR LEASE

3625 Lougheed Hwy  
Vancouver, BC



SPACE TYPE | OFFICE

ZONING | I-2

AVAILABLE SPACE | 1,926 SF

BASE RENT AND ADDITIONAL RENT | CONTACT LISTING SALES REPRESENTATIVE

## FEATURES

- 2nd floor office space comprising 1,926 square feet.
- Available immediately.
- Immediate access to Lougheed Highway, the Trans-Canada Highway and other main arterial routes serving Vancouver and Burnaby.
- Close proximity to the Millennium Line Skytrain and other public transit stations.
- Zoned I-2 Industrial District.
- Located in a fast growing neighbourhood with a good mix of commercial users. Many residential and commercial developments under construction or planned in the area.

This disclaimer applies to BGIS Global Integrated Solutions Realty Inc./BGIS Société Immobilière Solutions Globales Intégrées Inc. and to all other divisions of BGIS Global Integrated Solutions Canada LP ("BGIS"). The information set out herein, including, without limitation, any projections, images, opinions, assumptions and estimates obtained from third parties (the "Information") has not been verified by BGIS, and BGIS does not represent, warrant or guarantee the accuracy, correctness and completeness of the Information. BGIS does not accept or assume any responsibility or liability, direct or consequential, for the Information or the recipient's reliance upon the Information. The Information may change and any property described in the Information may be withdrawn from the market at any time without notice or obligation to the recipient. All Rights Reserved. Not intended to solicit anyone currently under contract.



BGIS Global Integrated Solutions Realty Inc.  
#301-535 Thurlow Street | Vancouver, BC | V6E 3L2 | 1-877-897-6844

# FOR LEASE

3625 Lougheed Hwy  
Vancouver, BC

## LOCATION MAP

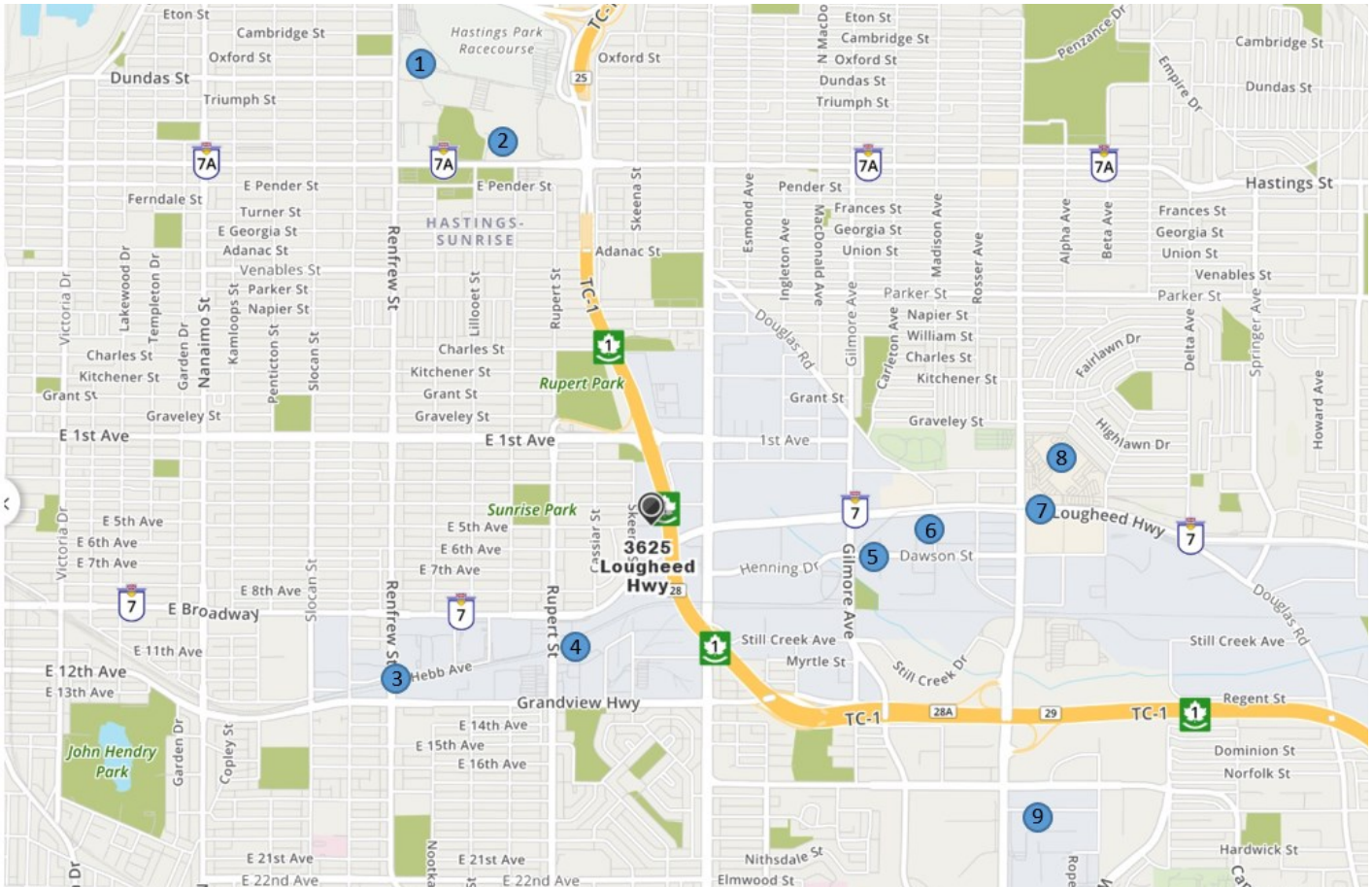

1. Pacific Coliseum
2. Pacific National Exhibition (PNE)
3. Renfrew Transit Station
4. Rupert Skytrain Station
5. Gilmore Skytrain Station
6. Gilmore Place (Proposed)
7. Brentwood Town Centre Station
8. Brentwood Town Centre
9. British Columbia Institute of Technology
10. Burnaby Hospital

This disclaimer applies to BGIS Global Integrated Solutions Realty Inc./BGIS Société Immobilière Solutions Globales Intégrées Inc. and to all other divisions of BGIS Global Integrated Solutions Canada LP ("BGIS"). The information set out herein, including, without limitation, any projections, images, opinions, assumptions and estimates obtained from third parties (the "Information") has not been verified by BGIS, and BGIS does not represent, warrant or guarantee the accuracy, correctness and completeness of the Information. BGIS does not accept or assume any responsibility or liability, direct or consequential, for the Information or the recipient's reliance upon the Information. The Information may change and any property described in the Information may be withdrawn from the market at any time without notice or obligation to the recipient. All Rights Reserved. Not intended to solicit anyone currently under contract.



BGIS Global Integrated Solutions Realty Inc.  
#301-535 Thurlow Street | Vancouver, BC | V6E 3L2 | 1-877-897-6844

# FOR LEASE

3625 Lougheed Hwy  
Vancouver, BC

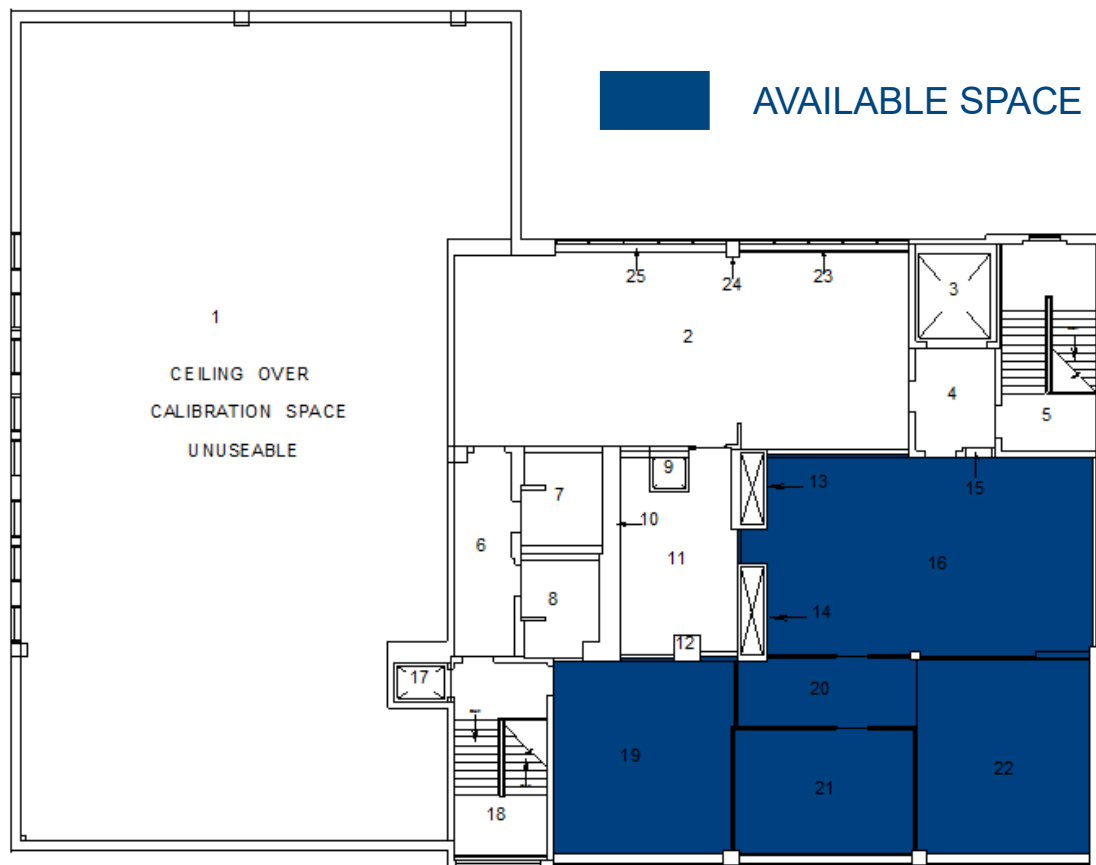

Lougheed Highway

## FOR MORE INFORMATION

ALEX LEE

Leasing and Tenant Relations Manager

Sales Representative

604.312.0653

[alex.lee@bgis.com](mailto:alex.lee@bgis.com)

This disclaimer applies to BGIS Global Integrated Solutions Realty Inc./BGIS Société Immobilière Solutions Globales Intégrées Inc. and to all other divisions of BGIS Global Integrated Solutions Canada LP ("BGIS"). The information set out herein, including, without limitation, any projections, images, opinions, assumptions and estimates obtained from third parties (the "Information") has not been verified by BGIS, and BGIS does not represent, warrant or guarantee the accuracy, correctness and completeness of the Information. BGIS does not accept or assume any responsibility or liability, direct or consequential, for the Information or the recipient's reliance upon the Information. The Information may change and any property described in the Information may be withdrawn from the market at any time without notice or obligation to the recipient. All Rights Reserved. Not intended to solicit anyone currently under contract.



BGIS Global Integrated Solutions Realty Inc.  
#301-535 Thurlow Street | Vancouver, BC | V6E 3L2 | 1-877-897-6844